

## MCSL 006TWP

### ABS WEATHER-PROOF IN-CEILING SPEAKER

#### Technical data

Frequency Response	150-18KHz
Sensitivity	91±3dB
Rated Power	6W
Power taps	3W/6W
Line input	100V
Hole for mounting	Φ125mm
Dimension(D*H)	Φ140*122mm
<b>Physical Specification</b>	
Material	ABS(white ral 9016)
Gill	Powder coated IRON mesh (White ral 9016)
Component	4"
Finished Colour	White ral 9016
Unit Weight	0.88Kg
Gross Weight	17.5kg/16pcs
Packing Dimension	62*32*40cm
<b>Speaker Specification</b>	
Voice Coil Size	0.12*2layer
DC Impedance	6.8Ω
Former	Kapton
Magnet	Ferrite(197g) Φ70*32*10(Y30)
Basket	Iron
Cone Material	Paper
Spider	Cloth
Dust cap	Mylar
Net Weight	410g

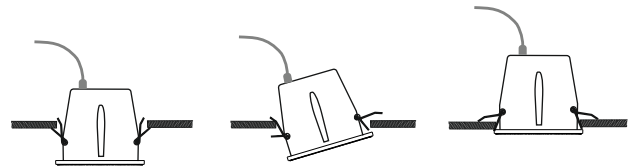
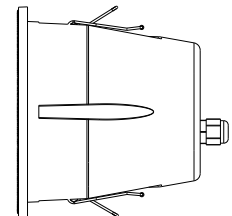
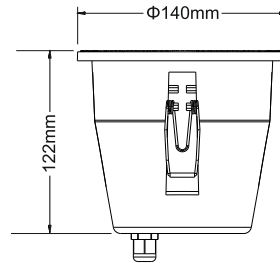

#### Frequency response

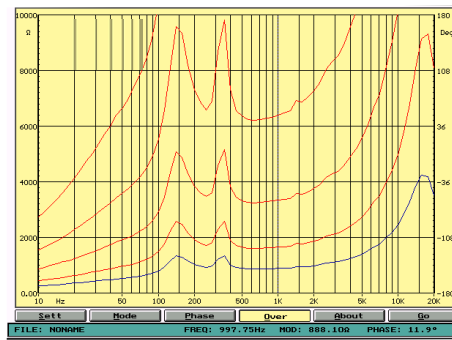
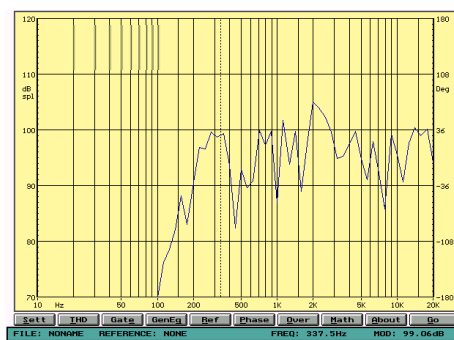

#### Polar response

