



General RAD Description

The entire family of RAD models interface with HAL or Mongoose, for digital conversion at the wall. Each converts analog audio to and/or from 24-bit, 48 kHz digital audio. Shielded CAT 5e (or better) cable and termination transport four digital audio channels – two channels each direction – as well as power, ground and a communications channel, with status indicators at each RAD, HAL, EXP or Mongoose unit, and in Halogen or Tracker software. The host HAL or Mongoose auto-checks the CAT 5 crimp and verifies audio. All RADs are both “location-aware” and hot-swappable with 500-foot homerun connections (66% farther than Ethernet). Light sensors dim the RAD indicators in dark rooms. Labels can be made and printed from Halogen or Tracker software.

RAD5

A RAD5 provides two AES3 digital inputs and two AES3 digital outputs on XLR connectors.

The RAD5 mounts in a standard 2-gang US electrical box. It is available in white, ivory, or black, with a matched Decora™ plate cover included. Order model RAD5W for white, RAD5I for ivory, and RAD5B for black.

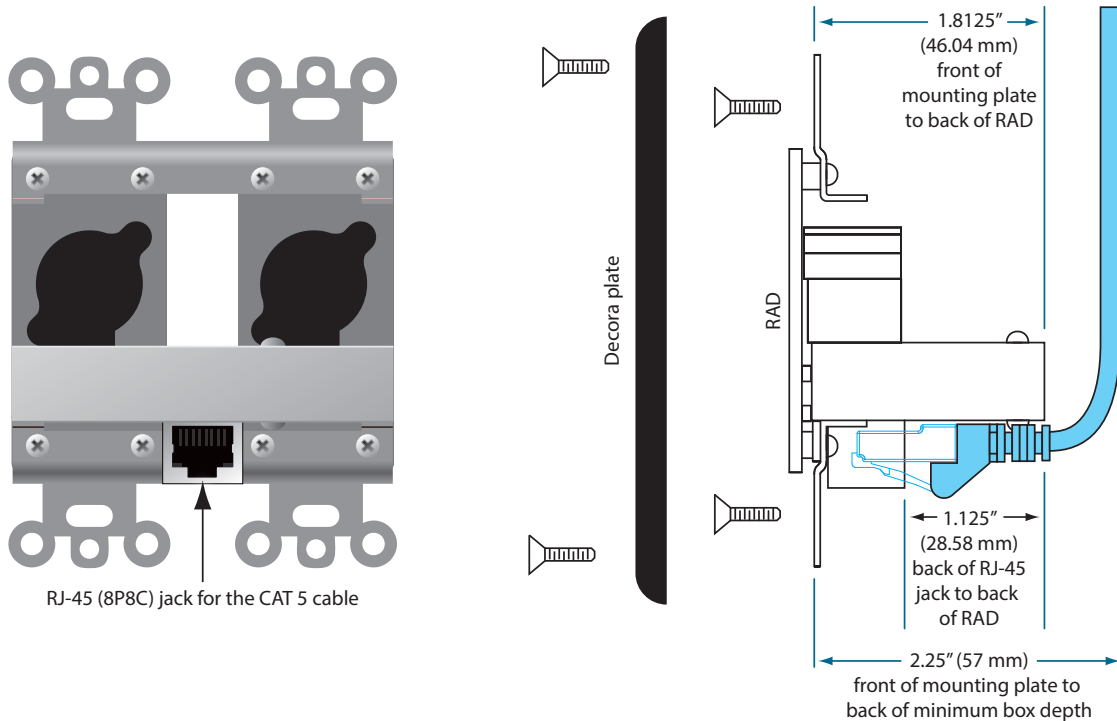

RAD Specifications

Parameter	Specification	Limit	Units	Conditions/Comments
Cable Length	500 feet / 153 meters			Shielded CAT 5e or better.
Lock Indicator	Digital input received			Green LED
AES3 (also AES/EBU)	IEC 60958 Type 1			Two channels of PCM audio on a balanced XLR cable.
Unit				
Conformity: EMC	2004/108/EC, 2002/96/EC, 2002/95/EC. EN55103-1:1996, EN55103-2:1996			
...FCC	Part 15B			Class B Device
Size	4.1"H x 3.1"W x 2.1"D			10.4 x 7.9 x 5.4 cm
...Weight	4.7 oz			133 g
.....Shipping	11 oz			312 g

